

Wichard Thimble Shackle - Captive Pin

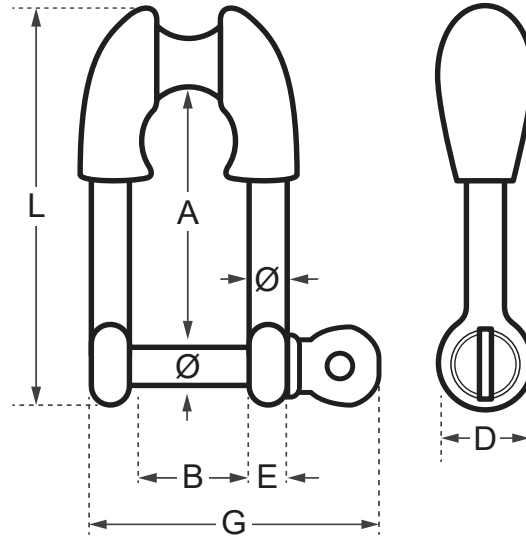

Code	Ø (mm)	L (mm)	A (mm)	B (mm)	D (mm)	E (mm)	G (mm)	Ø Rope Max (mm)	Working Load (kg)	Break Load (kg)	Weight (kg)
WD-1494	8	76	41	16	16	7	42	12	1000	3000	0.078
WD-1495	10	95	51	20	20	9	54	16	1520	5000	0.146

* Working Load refers to nautical applications,
For lifting and industrial applications the working load limit (WLL) is 1/5 of the break load.

A note about dimensional information

Please be aware that dimensions published on our site should be treated as indicative.

We publish dimensions to the best of our ability, however manufacturers can, from time to time, make small alterations to their designs.

If your dimensional criteria is critical please do contact us prior to making your purchase to let us know and we will do our best to fulfil your requirements.