

Collared Ring Bolt - Stainless Steel

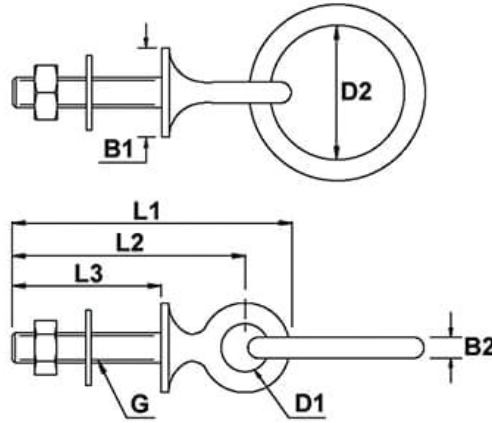

Code	G (mm)	L1 (mm)	L2 (mm)	L3 (mm)	B1 (mm)	B2 (mm)	D1 (mm)	D2 (mm)
CLRB-M6-030	M6	57	46	30	25	5	13	30
CLRB-M6-060	M6	87	76	60	25	5	13	30
CLRB-M8-035	M8	66	53	35	25	6	15	40
CLRB-M8-080	M8	111	98	80	25	6	15	40
CLRB-M10-050	M10	85	70	50	30	7	16	45
CLRB-M10-100	M10	135	120	100	30	7	16	45
CLRB-M12-100	M12	140	124	100	30	10	18	50
CLRB-M12-160	M12	200	184	160	30	10	18	50

A note about dimensional information

Please be aware that dimensions published on our site should be treated as indicative.

We publish dimensions to the best of our ability, however manufacturers can, from time to time, make small alterations to their designs.

If your dimensional criteria is critical please do contact us prior to making your purchase to let us know and we will do our best to fulfil your requirements.