

Deck Cleat - 2 Hole - Closed Base

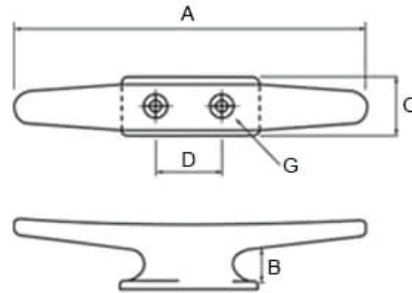

Code	A (mm)	B (mm)	C (mm)	D (mm)	G	Weight (kg)
DCC2-83	83	10	16.5	20	M5	0.03
DCC2-112	112	10	20	26	M5	0.06
DCC2-158	158	18	28	30	M6	0.15
DCC2-178	178	20	29	35	M6	0.25
DCC2-205	205	21	31.5	35	M6	0.26
DCC2-253	253	25	38.5	45	M10	0.50

A note about dimensional information

Please be aware that dimensions published on our site should be treated as indicative.

We publish dimensions to the best of our ability, however manufacturers can, from time to time, make small alterations to their designs.

If your dimensional criteria is critical please do contact us prior to making your purchase to let us know and we will do our best to fulfil your requirements.