

Stainless Steel Twist Shackle - Socket Head Pin

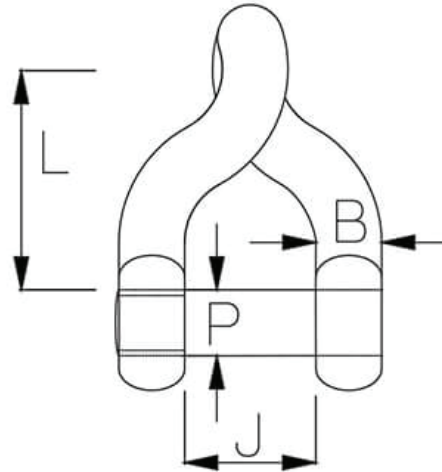

Option	Code	P (mm)	B (mm)	J (mm)	L (mm)	Break Load (kg)
5mm Shackle	T-050-C	5	5	10	16	1200
6mm Shackle	T-060-C	6	6	13	20	1600
8mm Shackle	T-080-C	8	8	16	26	2400
10mm Shackle	T-100-C	9.5	9.5	19	31	3800
11mm Shackle	T-110-C	11	11	22	35	4800
12mm Shackle	T-120-C	12.7	12.7	26	41	6000
16mm Shackle	T-160-C	16	14.3	29	45	8000
19mm Shackle	T-190-C	19	16	32	51	11000

A note about dimensional information

Please be aware that dimensions published on our site should be treated as indicative.

We publish dimensions to the best of our ability, however manufacturers can, from time to time, make small alterations to their designs.

If your dimensional criteria is critical please do contact us prior to making your purchase to let us know and we will do our best to fulfil your requirements.