

Master Link - Grade 100 - Alloy Steel

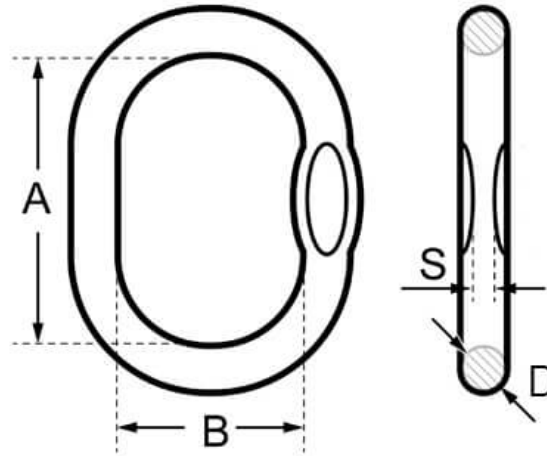

Code	1 Leg Chain Ø (mm)	2 Leg Chain Ø (mm)	WLL (tonne)	Weight (kg)	A (mm)	B (mm)	D (mm)	S (mm)
XN01011-10	6	5	1.4	0.14	80	50	10	N/A*
XN01011-13	7	6	2.3	0.34	110	60	13	7
XN01011-16	8	7	3.5	0.53	110	60	16	7
XN01011-18	10	8	5	0.86	135	75	18	8
XN01011-22	13	10	7.6	1.6	160	90	23	11
XN01011-26	16	13	10	2.46	180	100	27	13
XN01011-32	20/19	16	14	4.14	200	110	33	17
XN01011-36	22	20/19	25.1	6.22	260	140	36	19
XN01011-45	26	22	30.8	12.85	340	180	45	N/A*
XN01011-50	32	26	40	16.22	350	190	50	N/A*
XN01011-56	-	32	60	27	400	200	60	N/A*

*Note : 1.4, 30.8, 40 and 60 tonne master links are supplied without engineered flat (S).

A note about dimensional and loading information

Please be aware that dimensions and loads published on our site should be treated as indicative.

We publish this information to the best of our ability, however manufacturers can, from time to time, make small alterations to their designs.

If your dimensional criteria is critical please do contact us prior to making your purchase to let us know and we will do our best to fulfil your requirements.