

## Master Link - Grade 80 - Alloy Steel

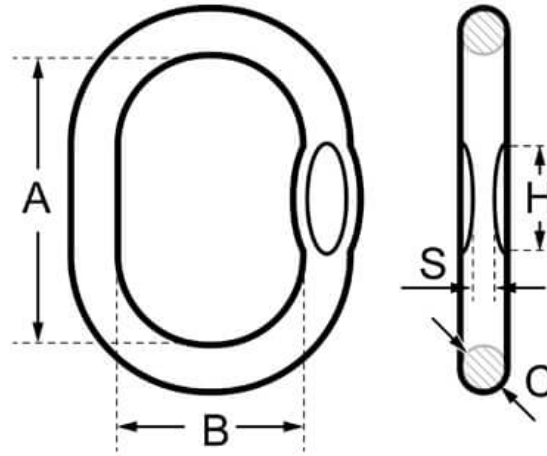

Code	1 Leg Chain Ø (mm)	2 Leg Chain Ø (mm)	WLL (tonne)	Weight (kg)	A (mm)	B (mm)	C (mm)	SxH (mm)
XN033-07-6	7	6	1.6	0.34	110	60	13	7x25
XN033-08-7	8	7	2.12	0.54	110	60	16	7x25
XN033-10-8	10	8	3.15	0.82	135	75	18	8x28
XN033-13-10	13	10	5.3	1.5	160	90	22	11x35
XN033-16-13	16	13	8	2.3	180	100	26	13x43
XN033-18-16	18	16	11.2	3.95	200	110	32	17x55
XN033-20-18	20	18	14	6.34	260	140	36	19x60
XN033-22-20	22	20	17	8.96	300	160	40	20x64
XN033-26-22	26	22	21.2	12.8	340	180	45	N/A*
XN033-32-26	32	26	31.5	16.55	350	190	50	N/A*
XN033-36-32	36	32	45	23.28	400	200	56	N/A*

\*Note : 21.2, 31.5 and 45 tonne master links are supplied without engineered flat (SxH).

A note about dimensional and loading information

Please be aware that dimensions and loads published on our site should be treated as indicative.

We publish this information to the best of our ability, however manufacturers can, from time to time, make small alterations to their designs.

If your dimensional criteria is critical please do contact us prior to making your purchase to let us know and we will do our best to fulfil your requirements.