

# Glass Shower Door to Glass Wall Profile

## 6mm glass shower door fitting with rise and fall mechanism

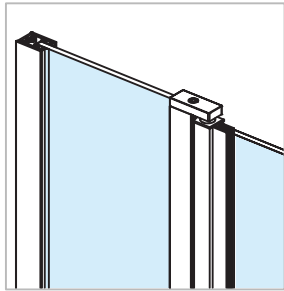

Options:

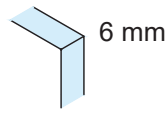

900 mm  
max

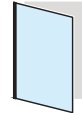
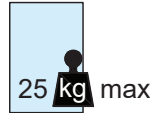

DIN left  
+  
DIN right

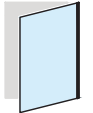

Material: Aluminium

Weight: 3.5 kg

Finish: Silver Matt Anodised    Chrome Design    Anthracite Black    Matt Brass Effect

Scope of supply:

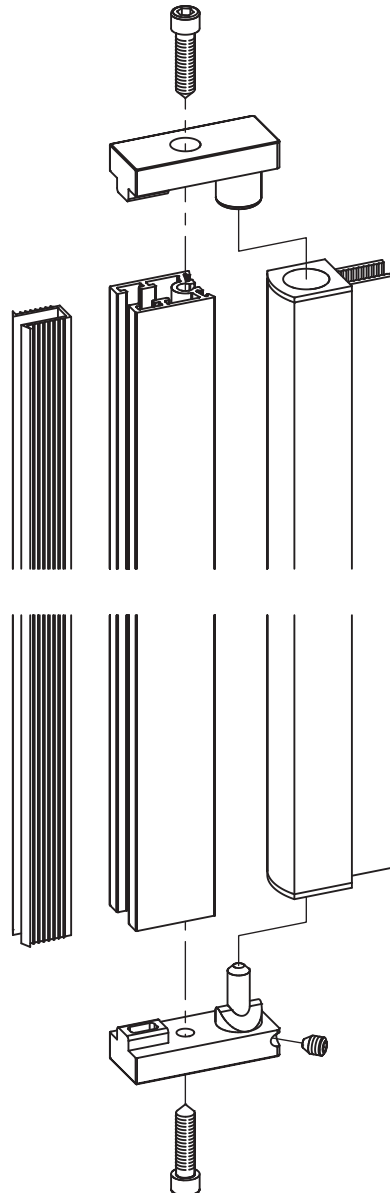
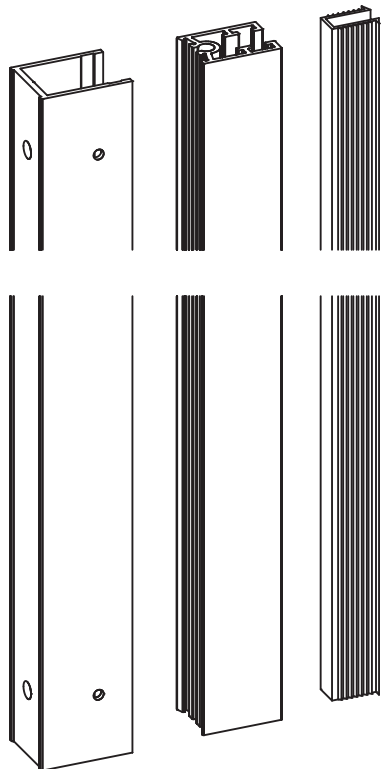
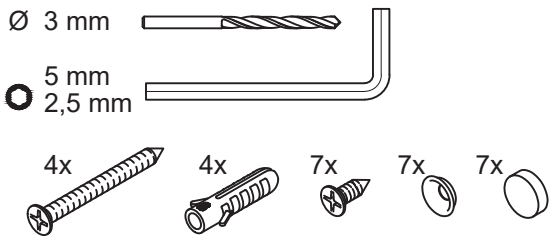

## Glass Shower Door to Glass Wall Profile

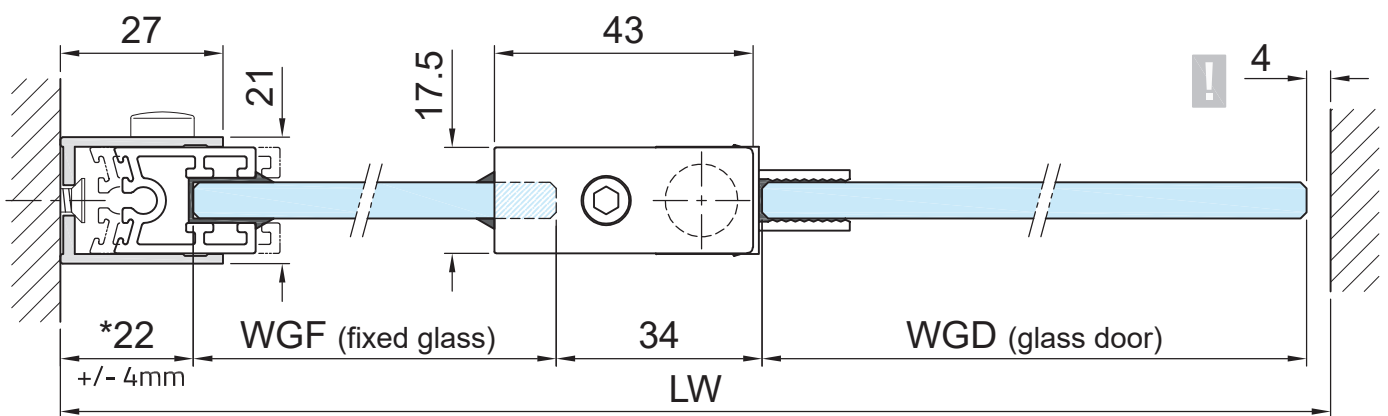
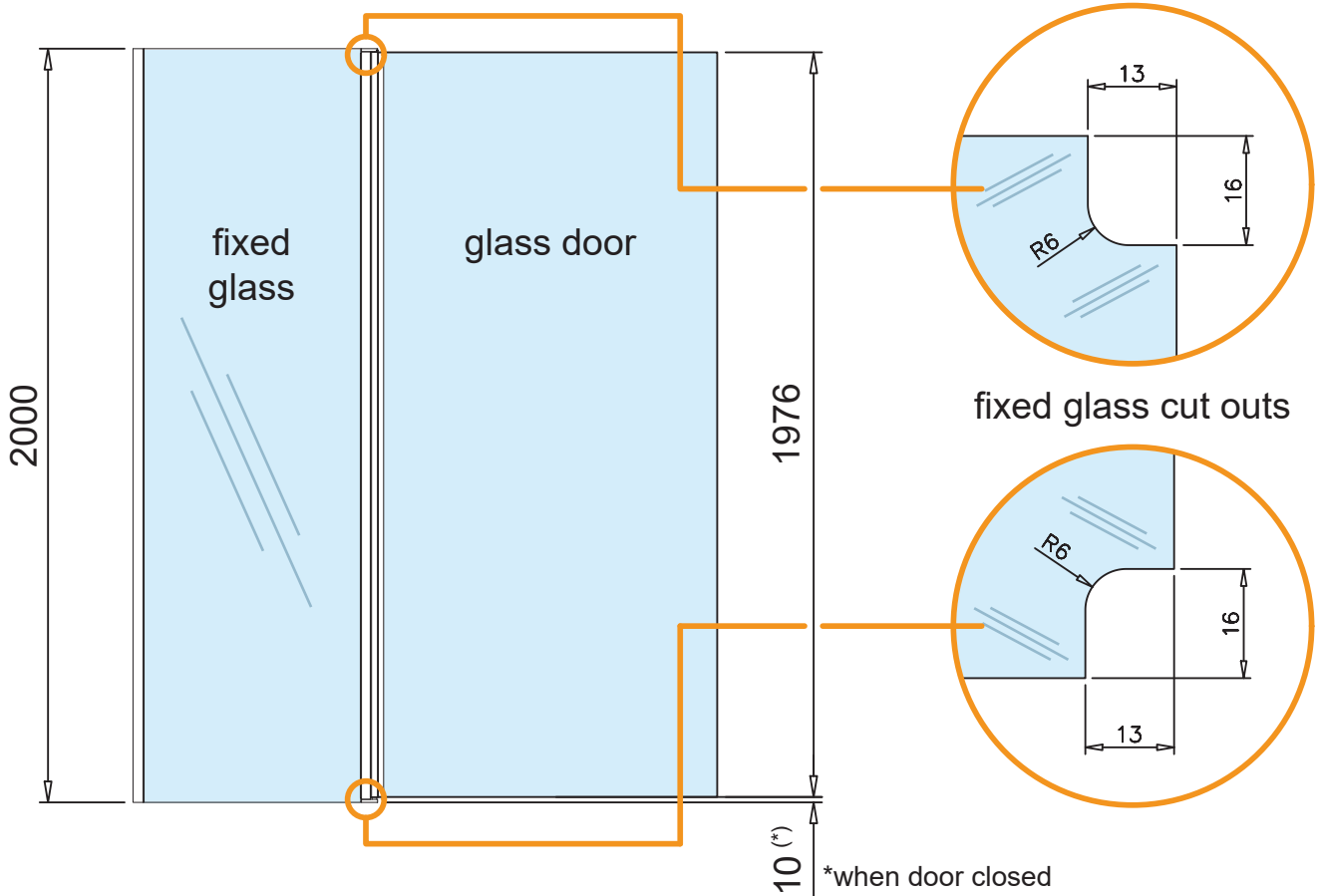

1.  $WFG \ \& \ WGD = WGT$  (width glass in total)
2.  $WGT_{(mm)} = LW - 60mm$
3. divide  $WGT$  into WFG and WGD as desired

\*averaged dimension in total 8mm wall levelling

**!** Glass door width shown here WITHOUT sealing profile. When using a sealing profile, please note the changed glass dimensions

# Glass Shower Door to Glass Wall Profile

## 1. Mounting the wall profile

1.1

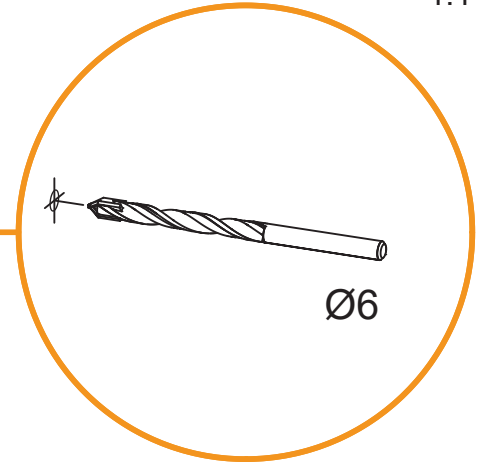
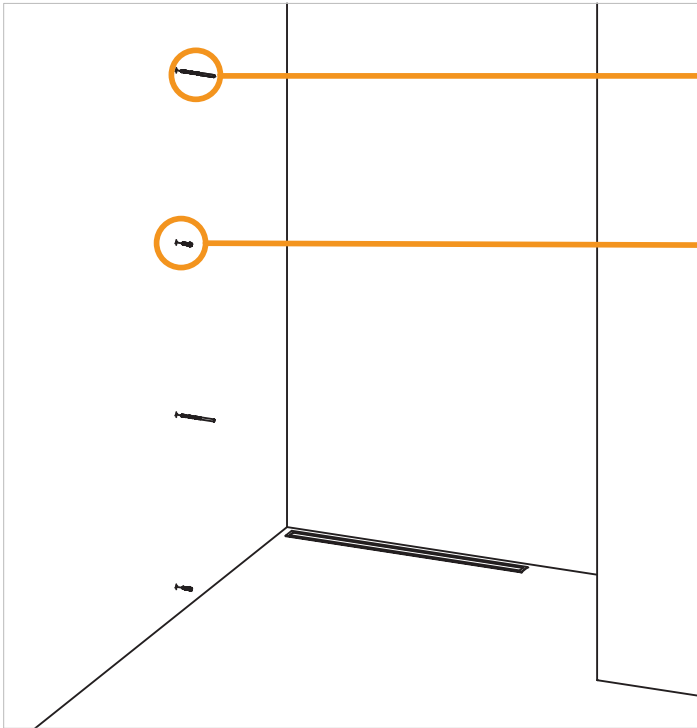

1.2

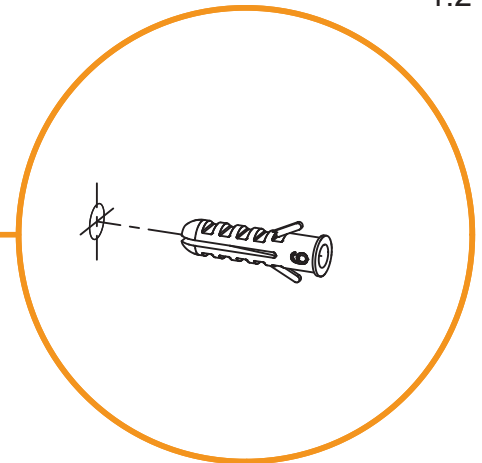

1.3

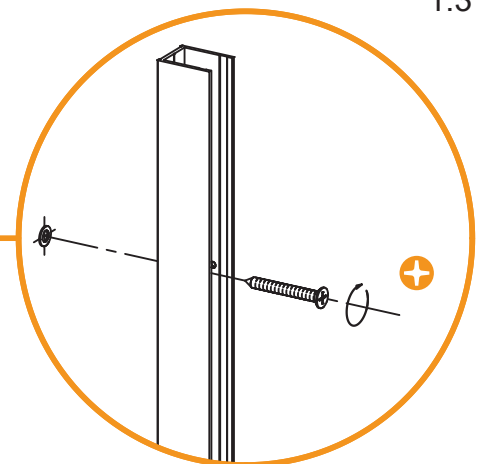
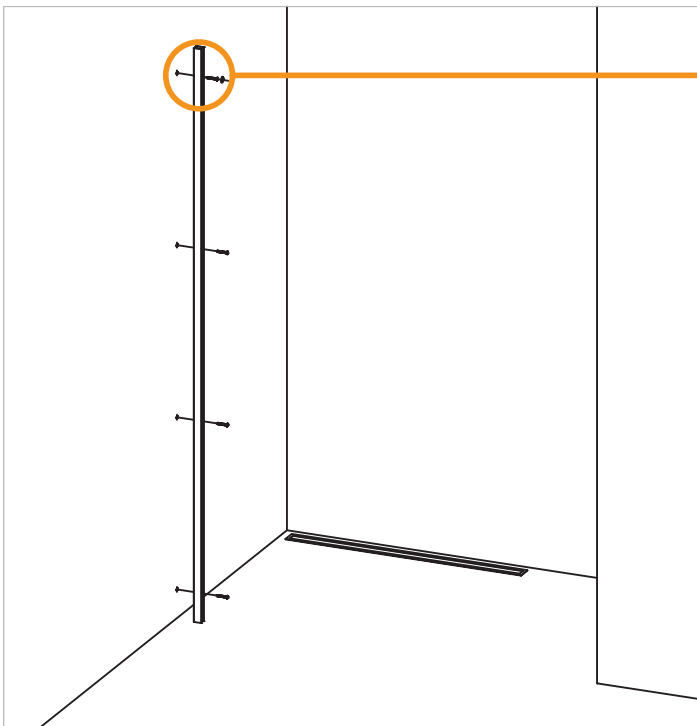

## Glass Shower Door to Glass Wall Profile

2. Mounting of the fixed glass:

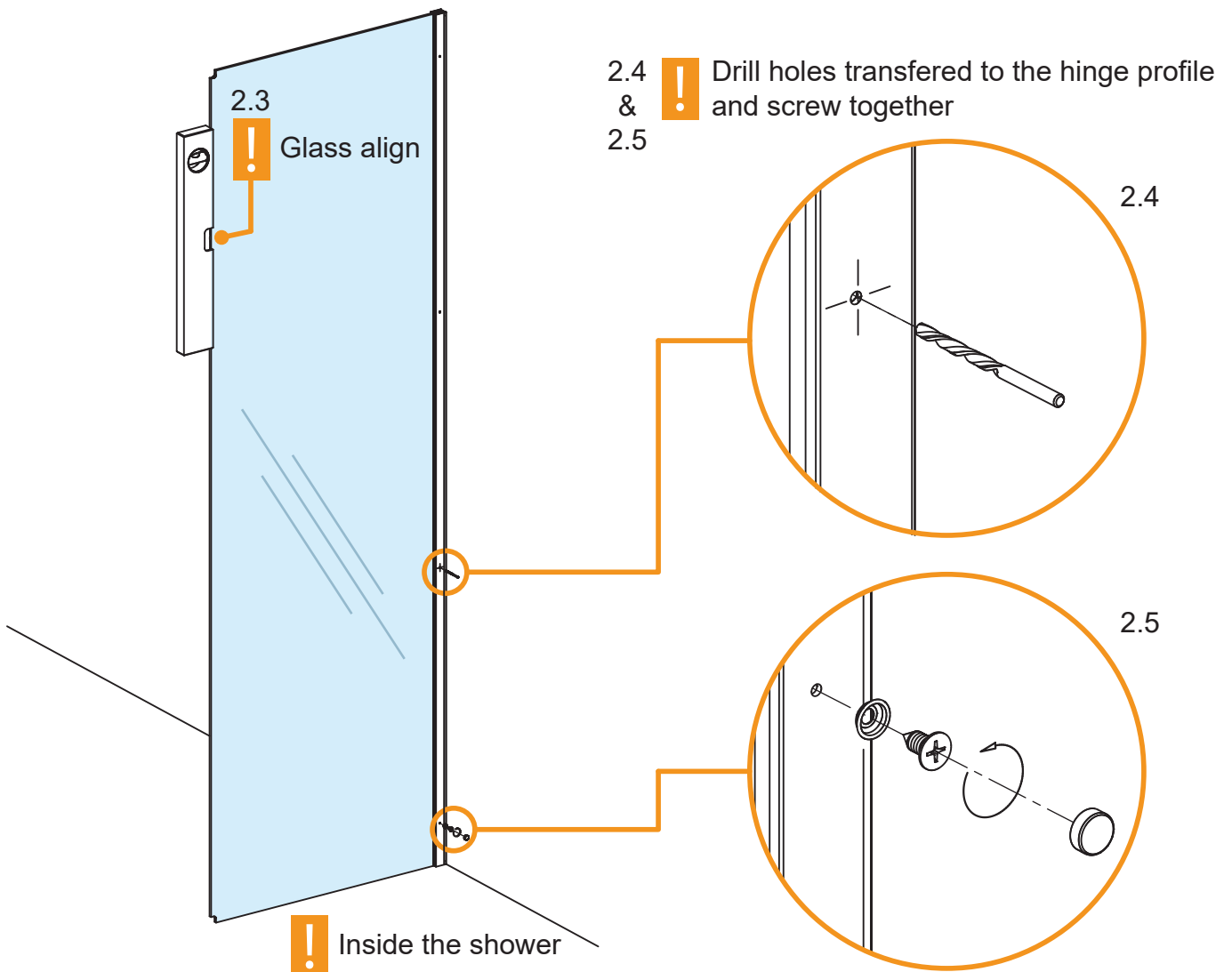
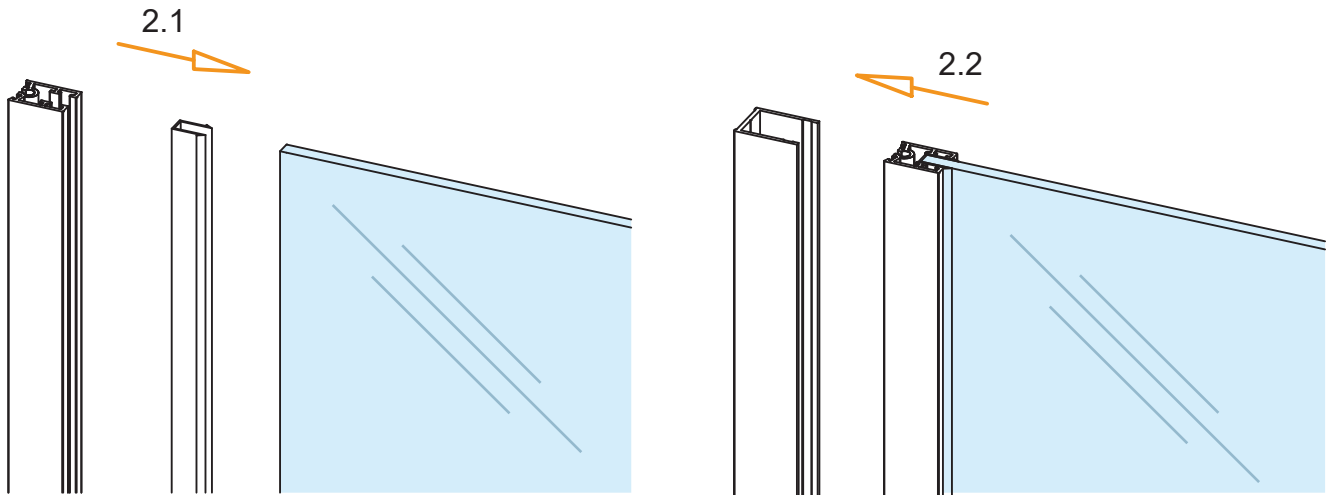

## Glass Shower Door to Glass Wall Profile

### 2. Mounting of the fixed glass:

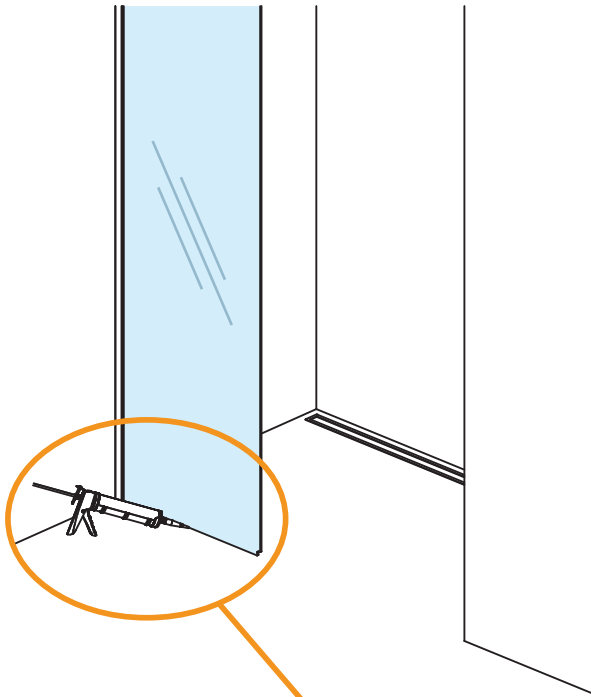

Optional: To improve stability, we recommend our reinforcement support bars, available separately.

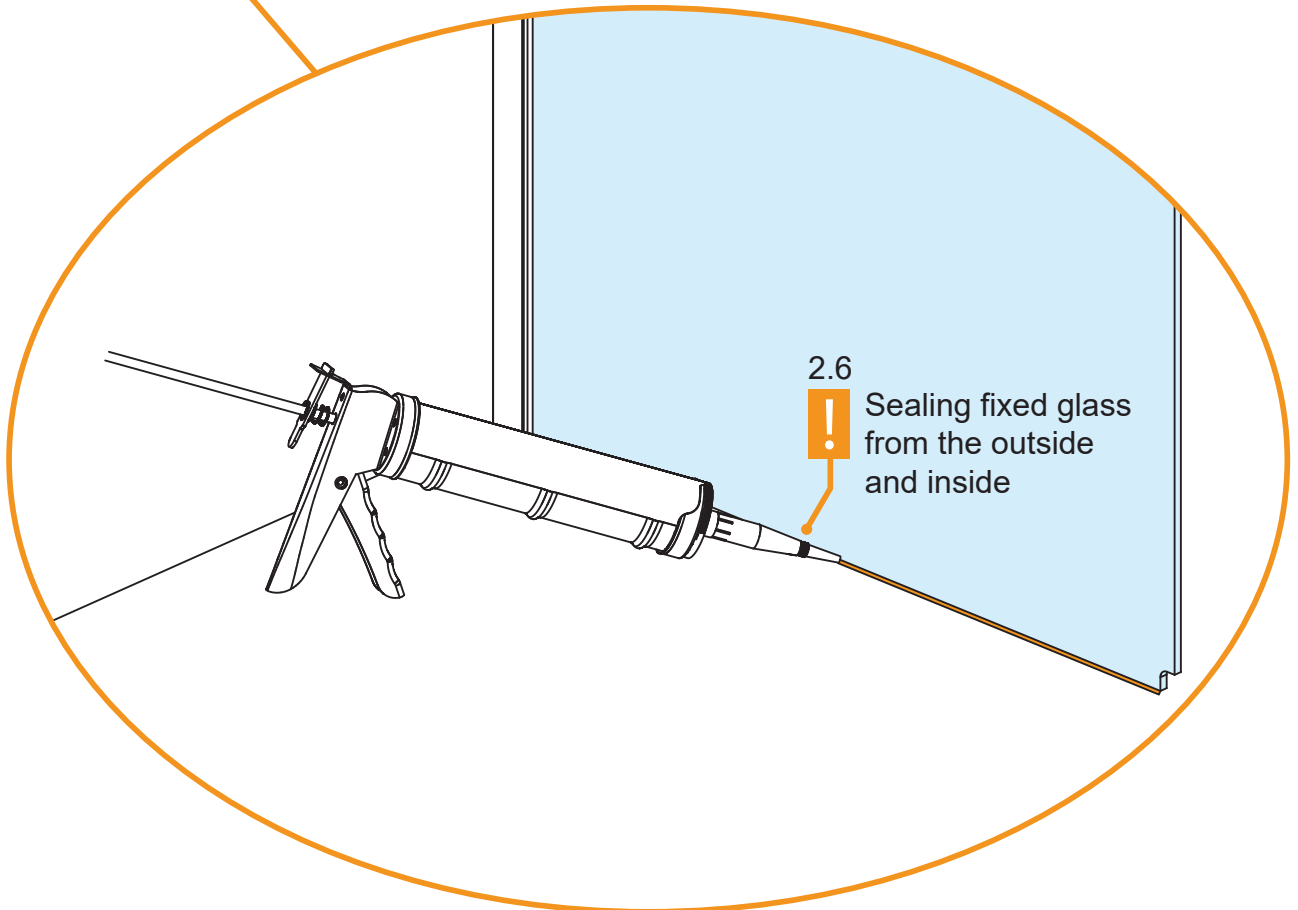

## Glass Shower Door to Glass Wall Profile

3 Mounting the door profile to the door glass:

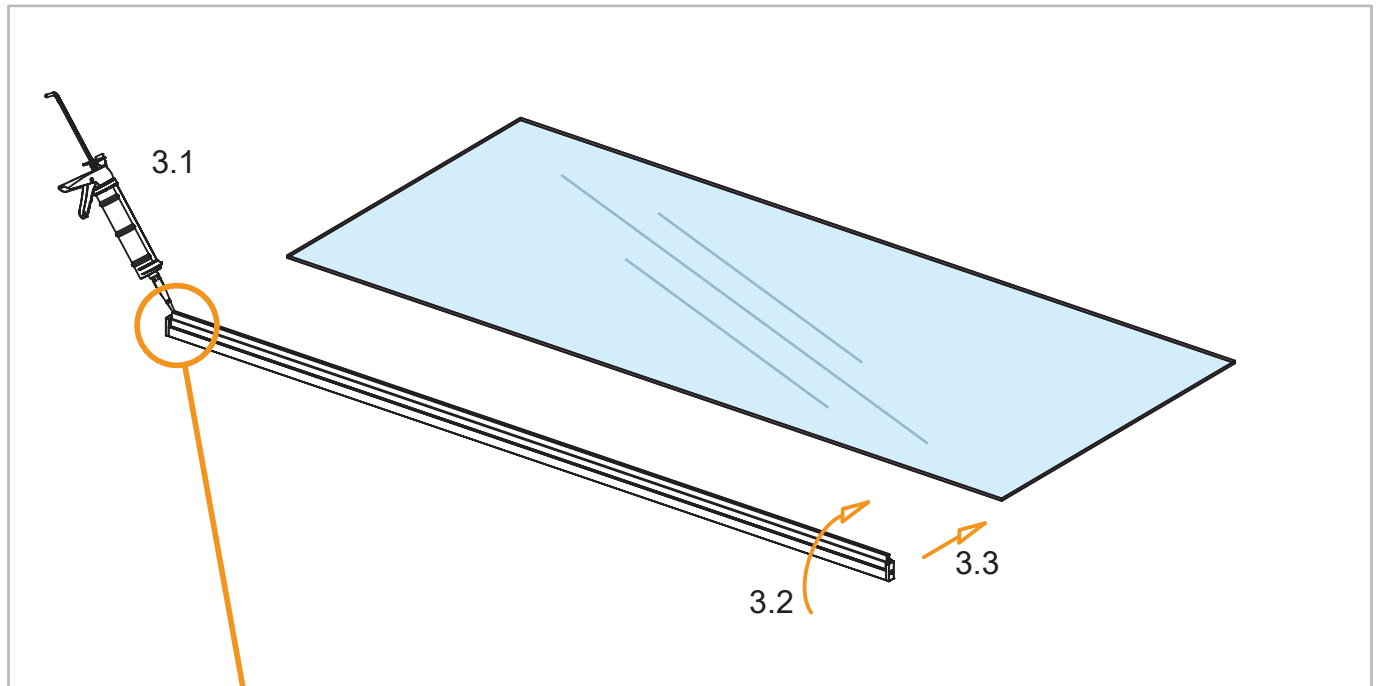

MS Polymer based adhesive

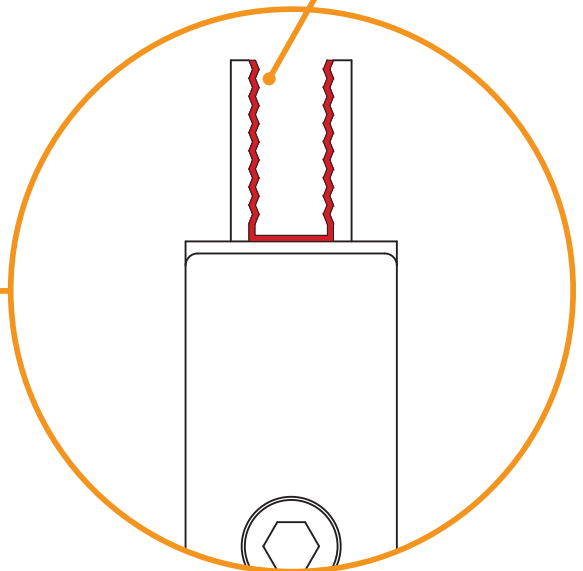
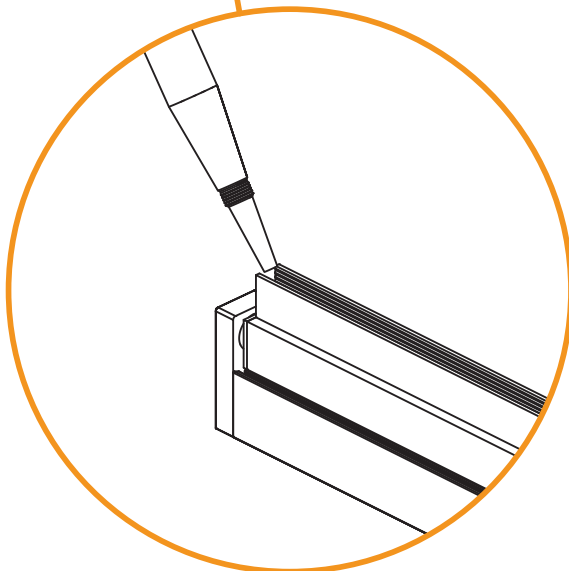

Important: Before mounting, clean the glass in the area of the bonding surface.

## Glass Shower Door to Glass Wall Profile

4 Mounting the glass door:

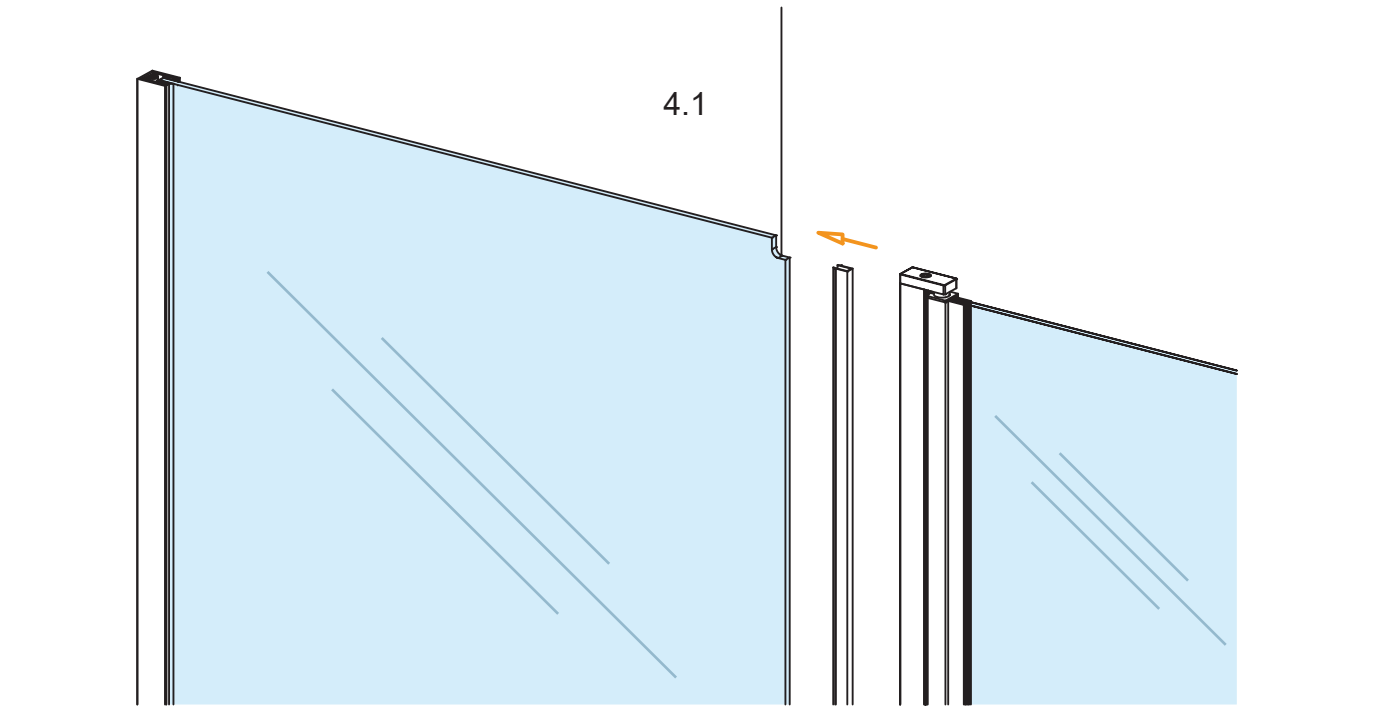

## Glass Shower Door to Glass Wall Profile

### 5 Setting the 0° position of the door

Top View

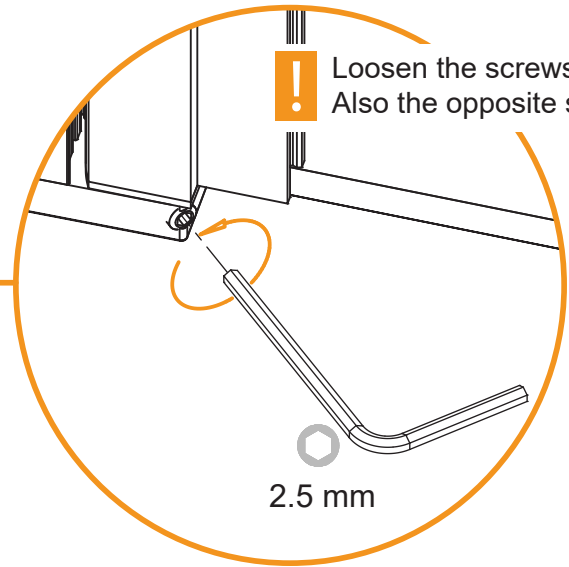
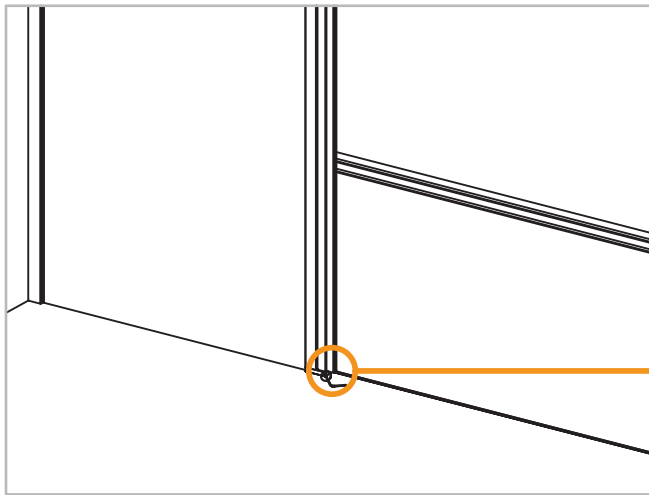

! Loosen the screws.  
Also the opposite side

2.5 mm

Top View

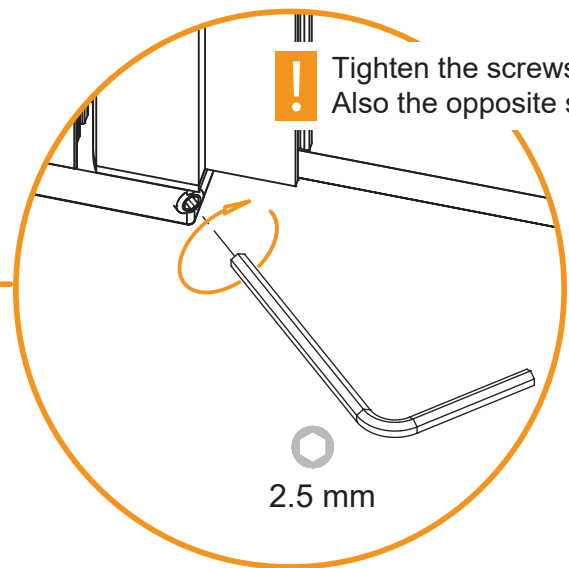
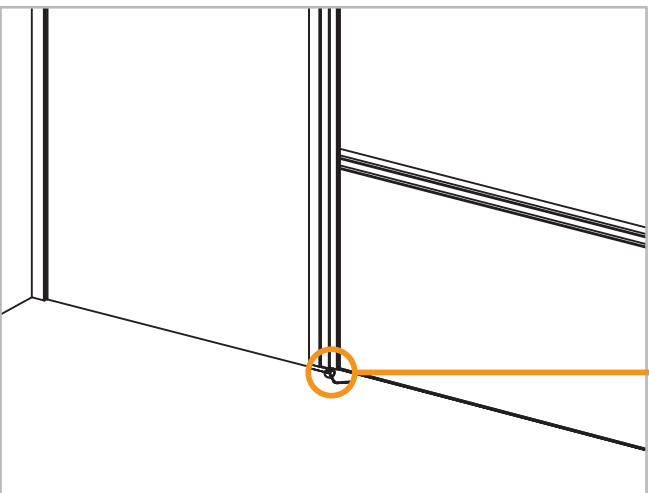
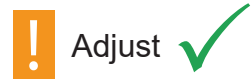

! Tighten the screws.  
Also the opposite side

2.5 mm