

Sta-Lok Threaded Strap Toggle Stud

UNF Thread

STA-LOK®

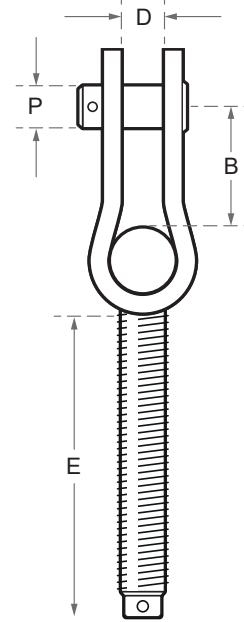

Left Hand Thread

Code	Thread (UNF)	Thread Type	B (mm)	D (mm)	E (mm)	P (mm)	Weight (kg)
STA-B18-14	1/4"	Left	14.4	6.4	57.0	6.4	0.040
STA-B18-516	5/16"	Left	19.0	8.4	60.0	7.9	0.060
STA-B18-38	3/8"	Left	20.0	9.9	70.0	9.5	0.100
STA-B18-716	7/16"	Left	25.0	11.5	75.0	11.1	0.160
STA-B18-12	1/2"	Left	28.0	13.1	81.0	12.7	0.260
STA-B18-58	5/8"	Left	33.0	16.3	89.0	16.0	0.480
STA-B18-34	3/4"	Left	34.0	19.1	125.0	18.5	0.700

Right Hand Thread

Code	Thread (UNF)	Thread Type	B (mm)	D (mm)	E (mm)	P (mm)	Weight (kg)
STA-B15-14	1/4"	Right	14.4	6.4	57.0	6.4	0.040
STA-B15-516	5/16"	Right	19.0	8.4	60.0	7.9	0.060
STA-B15-38	3/8"	Right	20.0	9.9	70.0	9.5	0.100
STA-B15-716	7/16"	Right	25.0	11.5	75.0	11.1	0.160
STA-B15-12	1/2"	Right	28.0	13.1	81.0	12.7	0.260
STA-B15-58	5/8"	Right	33.0	16.3	89.0	16.0	0.480
STA-B15-34	3/4"	Right	34.0	19.1	125.0	18.5	0.700

A note about dimensional information

Please be aware that dimensions published on our site should be treated as indicative.

We publish dimensions to the best of our ability, however manufacturers can, from time to time, make small alterations to their designs.

If your dimensional criteria is critical please do contact us prior to making your purchase to let us know and we will do our best to fulfil your requirements.