

## Wichard Folding Pad Eye - Titanium

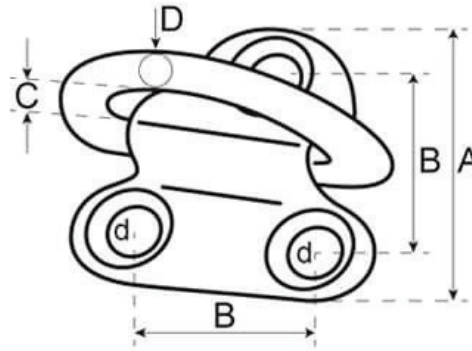

Code	A (mm)	B (mm)	C (mm)	D (mm)	Working Load (kg)	Break Load (kg)
WD-6564	45	27	14	6	1600	3000
WD-6565	59	35	17	8	2720	5000
WD-6566	75	45	23	10	4560	8500

### A note about dimensional information

Please be aware that dimensions published on our site should be treated as indicative.

We publish dimensions to the best of our ability, however manufacturers can, from time to time, make small alterations to their designs.

If your dimensional criteria is critical please do contact us prior to making your purchase to let us know and we will do our best to fulfil your requirements.